

(C)CFE series

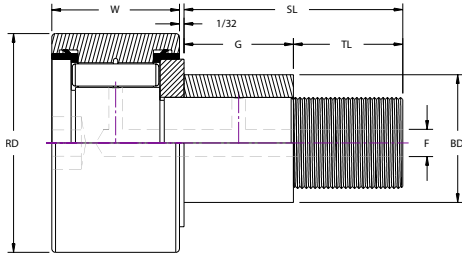

CFE

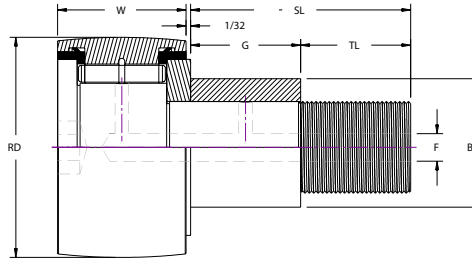

CCFE

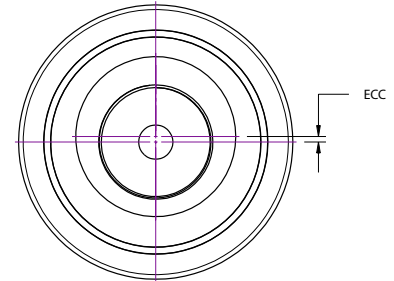

BEARING NUMBER	ROLLER DIA. (RD)	ROLLER WIDTH (W)	BUSHING LENGTH (G)	BUSHING DIA. (BD)	STUD LENGTH (SL)	THR D LENGTH (TL)	THR D	ECC.	LUB FIT SIZE (F)	MIN. BOSS DIA.	HOUSING BORE DIA. (+.0002/-0.0003)	CROWN RADIUS	CLAMP TRQ (in./lbs.)	STATIC CAPACITY (lbf)	DYNAMIC CAPACITY (lbf)
(C)CFE 1/2SB	0.5000	0.3750	0.375	0.250	0.625	0.2500	10-32	0.010	1/8*	19/64	0.1903	6	15	790	680
(C)CFE 9/16SB	0.5625	0.3750	0.375	0.250	0.625	0.2500	10-32	0.010	1/8*	19/64	0.1903	7	15	790	680
(C)CFE 5/8SB	0.6250	0.4375	0.437	0.375	0.750	0.3125	1/4-28	0.015	1/8*	23/64	0.2503	7	35	1215	955
(C)CFE 11/16SB	0.6875	0.4375	0.437	0.375	0.750	0.3125	1/4-28	0.015	1/8*	23/64	0.2503	7	35	1215	955
(C)CFE 3/4SB	0.7500	0.5000	0.500	0.500	0.875	0.3750	3/8-24	0.015	3/16	1/2	0.3753	8	95	2065	1660
(C)CFE 7/8SB	0.8750	0.5000	0.500	0.500	0.875	0.3750	3/8-24	0.015	3/16	1/2	0.3753	8	95	2065	1660
(C)CFE 1SB	1.0000	0.6250	0.500	0.625	1.000	0.5000	7/16-20	0.030	3/16	41/64	0.4378	10	250	3060	2225
(C)CFE 1 1/8SB	1.1250	0.6250	0.500	0.625	1.000	0.5000	7/16-20	0.030	3/16	41/64	0.4378	10	250	3060	2225
(C)CFE 1 1/4SB	1.2500	0.7500	0.625	0.687	1.250	0.6250	1/2-20	0.030	3/16	49/64	0.5003	12	350	4250	3930
(C)CFE 1 3/8SB	1.3750	0.7500	0.625	0.687	1.250	0.6250	1/2-20	0.030	3/16	49/64	0.5003	12	350	4250	3930
(C)CFE 1 1/2SB	1.5000	0.8750	0.750	0.875	1.500	0.7500	5/8-18	0.030	3/16	57/64	0.6253	14	650	5640	4840
(C)CFE 1 5/8SB	1.6250	0.8750	0.750	0.875	1.500	0.7500	5/8-18	0.030	3/16	57/64	0.6253	14	650	5640	4840
(C)CFE 1 3/4SB	1.7500	1.0000	0.875	1.000	1.750	0.8750	3/4-16	0.030	3/16	1 3/64	0.7503	20	1250	7920	6385
(C)CFE 1 7/8SB	1.8750	1.0000	0.875	1.000	1.750	0.8750	3/4-16	0.030	3/16	1 3/64	0.7503	20	1250	7920	6385
(C)CFE 2SB	2.0000	1.2500	1.000	1.187	2.000	1.0000	7/8-14	0.030	3/16	1 13/64	0.8753	20	1500	10570	8090
(C)CFE 2 1/4SB	2.2500	1.2500	1.000	1.187	2.000	1.0000	7/8-14	0.030	3/16	1 13/64	0.8753	20	1500	10570	8090
(C)CFE 2 1/2SB	2.5000	1.5000	1.125	1.375	2.250	1.1250	1-14	0.030	3/16	1 5/16	1.0003	24	2250	16450	11720
(C)CFE 2 3/4SB	2.7500	1.5000	1.125	1.375	2.250	1.1250	1-14	0.030	3/16	1 5/16	1.0003	24	2250	16450	11720
(C)CFE 3SB	3.0000	1.7500	1.250	1.750	2.500	1.2500	1 1/4-12	0.060	1/4	1 3/4	1.2503	30	3450	24910	15720
(C)CFE 3 1/4SB	3.2500	1.7500	1.250	1.750	2.500	1.2500	1 1/4-12	0.060	1/4	1 3/4	1.2503	30	3450	24910	15720
(C)CFE 3 1/2SB	3.5000	2.0000	1.375	1.812	2.750	1.3750	1 3/8-12	0.060	1/4	1 59/64	1.3753	30	4200	31625	22800
(C)CFE 4SB	4.0000	2.2500	2.000	2.000	3.500	1.5000	1 1/2-12	0.060	1/4	2 9/32	1.5003	30	5000	44770	29985

*Oil hole (F) drilled from flange end of the stud to the radial oil hole only.

(Unless otherwise specified, all dimensions are listed in inches.)